

WASHER t=0.4

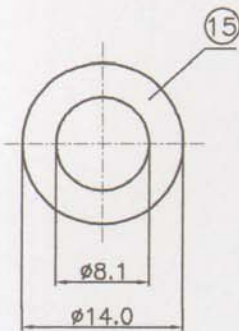

NUT 1PC

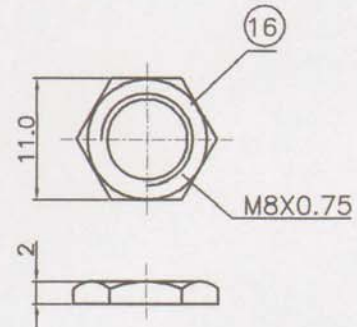

17	WTH-189	Butter			
16	N-8(GN)	Nut	1	Steel	Zinc Plating
15	W-8(GN)	Washer	1	Steel	Zinc Plating
14	R2741-4	Screw Bolt	2	SPC	Zinc Plating
13	R2715	Spring Piece	1	Phosphor-braze	No Plating
12	R2708C	Block C	1	POM	No Plating
11	R2731	Tubing	3	POM	No Plating
10	R2712	Washer	3	SPCC	No Plating
9	R16007B	Wiper	4	Phosphor-braze	Ag Plating
8	R162S308	Block	4	POM	No Plating
7	R2713	Sticker	1		No Plating
6	R2721	Wash	1	SPCC t=0.5	No Plating
5	R2705	Terminal Lug	12	SPCE	Tin
4	R2704	Element	4	Glass fiber t=1.2	No Plating
3	R2709	Case	2	POM	No Plating
2	R2702	Bushing	1	Zinc	No Plating
1	R27201- 20K	Shaft	1	Aluminum	No Plating

No.	Model	T	M	K	L
	20K	9	2	13	20

NO	Part No	Description	QTY	Material	Finishing	MODEL	R274-20-20K-B	K (G)	A
TOLERANCES		DIMENSION	SCALE	DRAWING BY	CHECKED BY	APPROVED BY	DRAWING NO.		
less than 10	± 0.3	m/m	/	李 Dec.10'12 友群	江 2012.12.10 秋彦	江 2012.12.10 秋彦	R274-01		
above 10 - 30	± 0.5						R27\Spec		
above 30 - 100	± 1.0								
angular dimension	± 5'								