

BOTTOM VIEW
P.C.B TOLERANCE ±0.10
Recommended PCB thickness:1.6 mm

6	ND1 PIN	2		Sn	
5	Receiver	1			
4	Spring	1	SWPA		BLACK
3	Shutter	1	NYLON PA-66		BLACK
2	Case	1	NYLON PA-66		BLACK
1	Body	1	NYLON PA-66		BLACK
NO	PART NAME	QTY	MATERIAL	PLATED	REMARK

<div> INDUSTRIAL CO., LTD.</div> <div>LIH SHENG PRECISION</div>					
TOLERANCE		Material	PART NAME	OPTICAL CONNECTOR	
X. ±0.5		Thickness	PART NO.	LOC0701R-08ABB	
X.X ±0.3		Disposal	DATE	06/12/06	
X.XX ±0.15		UNIT	DRAW	CHECK	
		mm	Jacky	Chris	
			1:1	APPROVE	
				Cooper	

Receiver	①	Vcc
	②	GND
	③	Vout

仕 樣 書 SPECIFICATION

CUSTOMER MODEL NO. / TITLE OPTICAL RECEIVERING JACK	SPECIFICATION NO. LOC0701R-08 系列 LOC0701RA-08 系列	PAGE : 1 OF 4 DATE : NOV,17,2006
--	--	-------------------------------------

OPTICAL CONNECTOR

1. FEATURES

- (1) Data transmission rates (100Kbps ~ 12.5Mbps)
- (2) Operating voltage (4.5 to 5.5V)
- (3) Directly connectable to demodulation IC for digital audio equipment
- (4) Peak sensitivity wavelength ($\lambda=700\text{nm}$)

2. APPLICATIONS

- (1) Digital optical Data-links
- (2) Dolby AC-3 Digital Audio Interface
- (3) PC Sound Card
- (4) MD Player

APPLICATION CIRCUIT

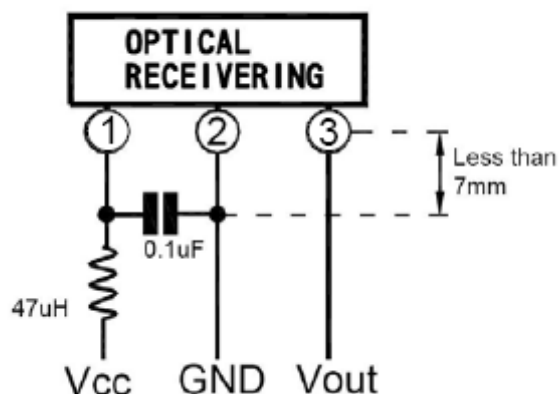

3. ABSOLUTE MAXIMUM RATINGS (Tamb=25°C)

Characteristic	Symbol	Rating	Unit
Supply voltage	VCC	0.5 ~ 7.0	V
Storage Temperature	Tstg	-30 ~ 80	°C
Operating Temperature	Topr	-20 ~ 70	°C
Soldering Temperature	TSOL	260 *	°C

* Soldering time \leq 10s.

核 示	審 核	確 認	作 成
Cooper	Ken	Jacky	Chris

仕 樣 書 SPECIFICATION

CUSTOMER MODEL NO. / TITLE OPTICAL RECEIVING JACK	SPECIFICATION NO. LOC0701R-08 系列 LOC0701RA-08 系列	PAGE : 2 OF 4 DATE : NOV,17,2006
--	--	-------------------------------------

4. ELECTRICAL CHARACTERISTICS (Tamb=25°C)

Characteristics	Symbol	Test condition	Min.	Typ.	Max.	Unit
Operating Voltage	VCC		4.5	5.00	5.5	V
Peak Detective Wavelength	λ_p		---	700	---	nm
Transmission Speed	T	NRZ signal	0.1	8	---	Mbps
Transmission Distance		Using APF	0.2	--	5	m
Input Light Power	Pf		-24	--	-14.5	dBm
Dissipation Current	ICC		--	5	8	mA
High Level Input Voltage	VOH		2.4	4.8	--	V
Low level Input Voltage	VOL		--	0.2	0.4	V
Rise Time	tr			6	30	ns
Fall Time	tf			6	30	ns
Duty Ratio			40	--	60	%
Jitter time	Δt_j	Pc=15dBm	--	1	30	ns

BLOCK DIAGRAM

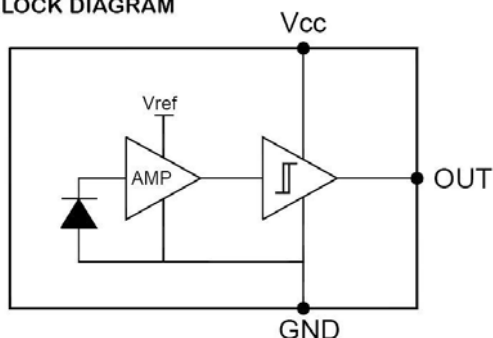

5. Mechanical Characteristics

Parameter	Symbol	MIN.	TYP.	MAX.	Unit
5.1 Insertion force. Withdrawal force.	-	4	-	40	N

5.2 Repeated operation

Inserting and withdrawing shall be made at a speed of 20 times or less/min using mating plug (Refer to page 5) 500 times.

5.3 Strength of tapping part

The tapping part shall be capable of a torque of 8kgf-cm for 5 seconds by TP3 ×8 tapping tight screw and panel (t=0.8), the jack shall not be broken.

核 示	審 核	確 認	作 成
Cooper	Ken	Jacky	Chris

仕 樣 書 SPECIFICATION

CUSTOMER MODEL NO. / TITLE OPTICAL RECEIVERING JACK	SPECIFICATION NO. LOC0701R-08 系列 LOC0701RA-08 系列	PAGE : 3 OF 4 DATE : NOV,17,2006
---	--	--

PULSE RESPONSE MEASURING METHOD

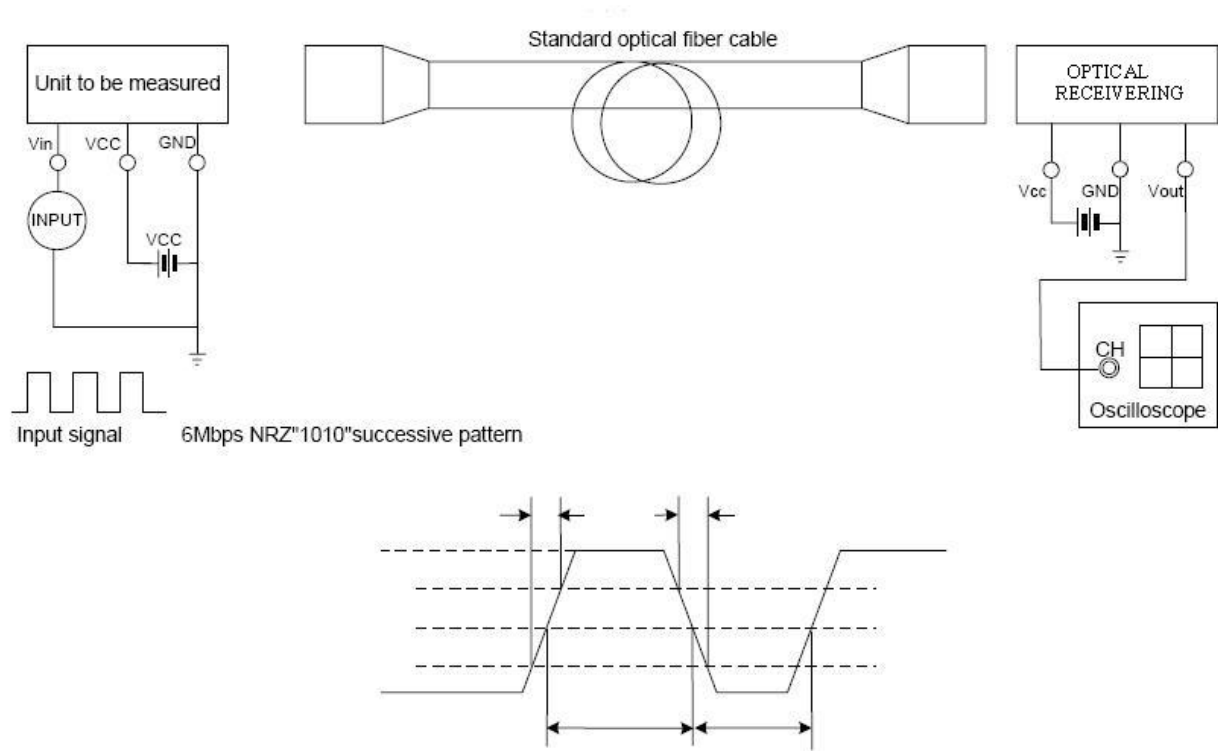

- NOTE:
- 1. Standard fiber optical cable (POF,1m)
 - 2. The optical power meter must be calibrated to have the wavelength sensitivity of 660nm.(0dBm=1Mw)
 - 3. To bundle up the standard fiber cable, make it into a loop with the diameter of 10cm or more.

核 示	審 核	確 認	作 成
Cooper	Ken	Jacky	Chris

仕 樣 書 SPECIFICATION

CUSTOMER MODEL NO. / TITLE	SPECIFICATION NO.	PAGE : 4 OF 4
OPTICAL RECEIVERING JACK	LOC0701R-08 系列 LOC0701RA-08 系列	DATE : NOV,17,2006

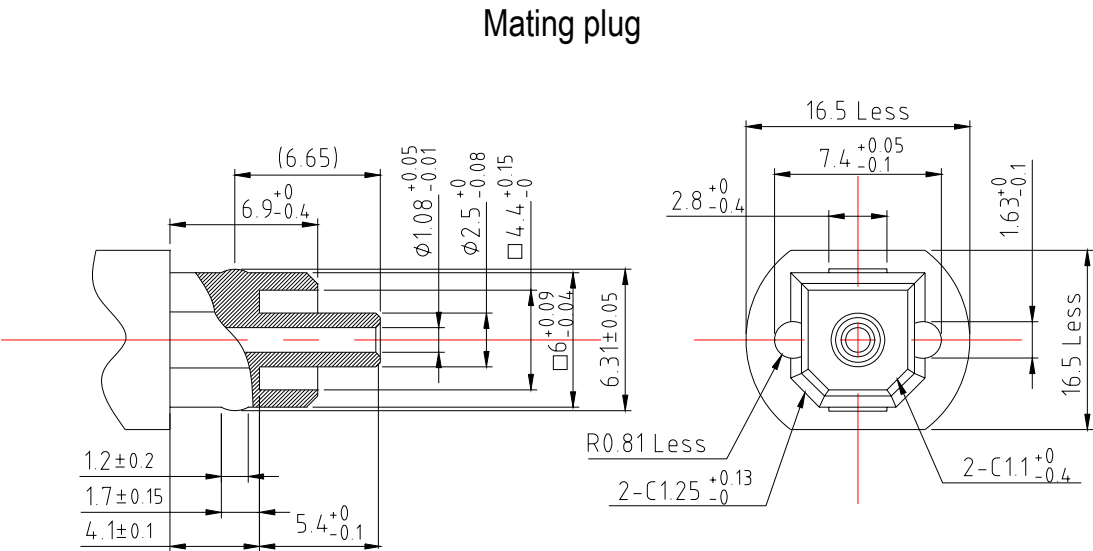

Unit:mm

核 示	審 核	確 認	作 成
Cooper	Ken	Jacky	Chris

MESSRS

公司名稱：F.K. INGENIEURBURO

DATE : 2007/04/13

承認申請書 APPROVAL SHEET

品名：OPTICAL CONNECTOR DESCRIPTION
立生料號：LOC0701R-08ABB LIH SHENG P/N
客戶料號： CUSTOMER P/N
使用機種： MODEL NO.

APPROVED BY 承認欄

--

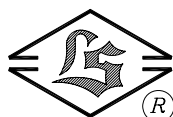

®

立生精密工業股份有限公司

LIH SHENG PRECISION IND.CO.,LTD.

4F.,NO.82,Sec.1,Kuang Fu Road,San Chung City,
Taipei Hsien,Taiwan,R.O.C.

TEL:886-2-2995-6555 FAX:886-2-2995-6551

東莞立生電子有限公司

Golden Lake Industrial District,Qishi Town ,
Dongguan City, Guang Dong Province,China

TEL:86-769-8676-2188 FAX:86-769-8676-2868

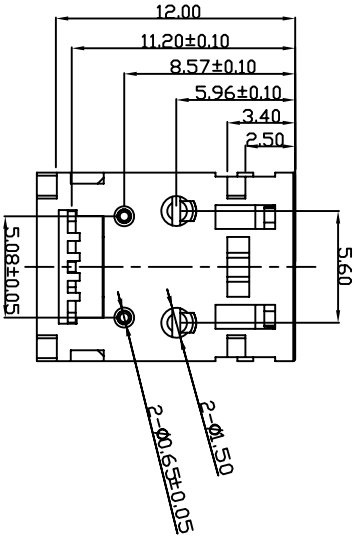
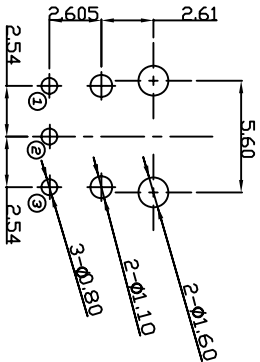
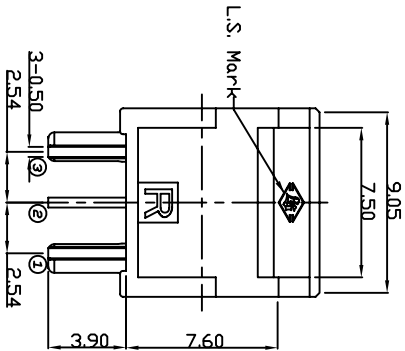
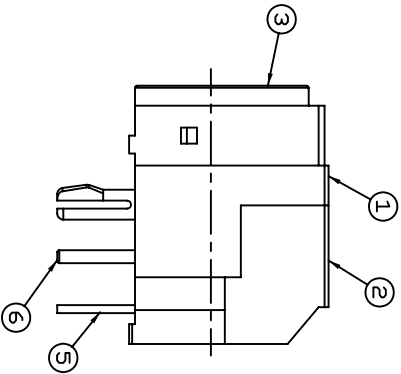
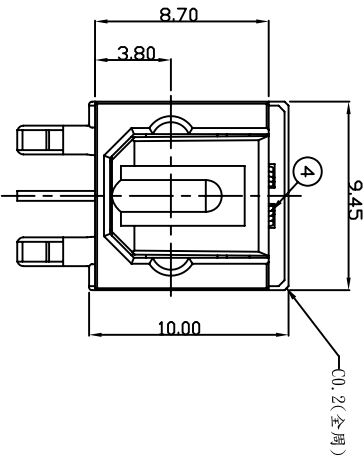
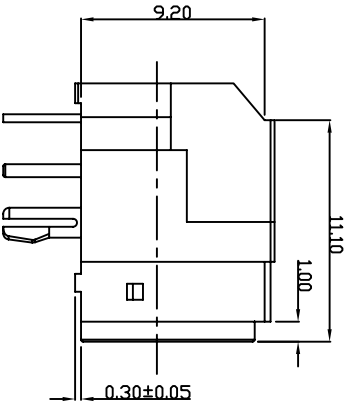
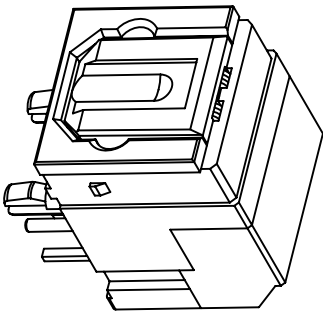
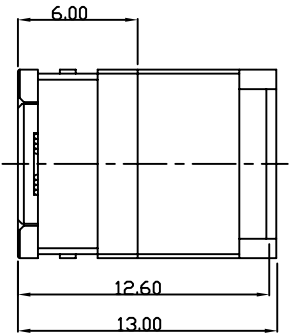

BOTTOM VIEW
P.C.B TOLERANCE ±0.10
Recommended PCB thickness:1.6 mm

6	ND1 PIN	2		Sn	
5	Receiver	1			
4	Spring	1	SWPA		BLACK
3	Shutter	1	NYLON PA-66		BLACK
2	Case	1	NYLON PA-66		BLACK
1	Body	1	NYLON PA-66		BLACK
NO	PART NAME	QTY	MATERIAL	PLATED	REMARK

<div> ® LIH SHENG PRECISION INDUSTRIAL CO., LTD.</div>					
TOLERANCE		Material	PART NAME	OPTICAL CONNECTOR	
X. ±0.5		Thickness	PART NO.	LOC0701R-08ABB	
X.X ±0.3		Disposal	DATE	06/12/06	
X.XX ±0.15		UNIT	DRAW	CHECK	
		mm	Jacky	Chris	
			1:1	APPROVE	
				Cooper	

Receiver	①	Vcc
	②	GND
	③	Vout

QMFZ2
Component-Plastics

October 6, 1994

E I DUPONT DE NEMOURS & CO INC

E41938(M)
(1020-cont from 1016 card)

70G33HRL	NC.	0.71	94HB	120	105	120	4	0	-	-	-
	BK	1.5	94HB	120	105	120	4	0	1	-	-
		3.0	94HB	120	105	120	4	-	1	5	0
	All	0.71	94HB	105	65	105	4	0	-	-	-
70G33L		1.5	94HB	120	105	120	4	0	1	-	-
		3.0	94HB	120	105	120	4	0	1	5	1
		0.71	94HB	115	95	115	4	0	-	-	-
		1.5	94HB	125	105	125	4	0	0	-	-
70G33HSL		3.0	94HB	120	105	120	4	0	1	5	1
	NC,BK	0.71	94HB	115	95	115	4	0	-	-	-
		1.5	94HB	125	105	125	4	0	0	-	-
		3.0	94HB	130	105	130	4	0	0	5	1
70G30PSR		0.71	94HB	120	105	120	4	0	-	-	-
	NC,BK	1.5	94HB	120	105	120	4	0	1	-	-
		3.0	94HB	120	105	120	4	-	1	5	0
		0.71	94HB	120	105	120	4	-	1	5	0

Reports:March 31, 1969;December 7, 1922;August 2, 1994;October 14, 1994.

Replaces E419381020 dated July 25, 1994.

(Cont. on 1025 card)

324299147 N7047 Underwriters Laboratories Inc. (A) D11/0237223

Du Pont de Nemours International S.A.
2, chemin du Pavillon
CH-1218 Le Grand-Saconnex / Geneva
Switzerland
Tel. +41 22 717 6755 / Fax. 6602



Statement

We hereby certify that during manufacture of

ZYTEL® 70G33L NC010

Nylon resin

ISO 1043 abbreviated term:

PA66-GF33

ISO 11469 part marking code:

>PA66-GF33<

no flame-retardant system is added.

No polybrominated biphenyls (PBB), polybrominated diphenyls (PBD), polybrominated biphenyl oxides/ester/ether (PBBO/PBBE) or polybrominated diphenyl oxides/ester/ether (PBDO/PBDE) are added.

For additional information, please consult the Safety Data Sheet / Product information.

Important: Use good manufacturing practice and assure properly operating exhaust ventilation when processing the above resin to keep volatiles within exposure limits. Before use, please refer to relevant safety, handling and processing information.

Processing and material / part handling conditions may influence chemical content and emission behaviour of finished parts.

This declaration only refers to entries applicable to polymer compounds as delivered.

To the best of our knowledge, our raw material suppliers do not use the above substances in the manufacture of their products. However, we do not routinely analyse our resins for the above substances nor do we require our raw material suppliers to do so.

Rainer Kurzknabe
Regulatory Affairs Programs Manager

This statement is based on our current level of knowledge and covers commercial and experimental resins as supplied by DuPont at the date of issue. Since conditions of use are outside DuPont's control, DuPont makes no warranties, express or implied, and assumes no liability in connection with any use of this information.

E&E-0

® DuPont registered trademark

European Directive 2002/95/EC (RoHS) and European Directive 2002/96/EC (WEEE), European Directive 2003/11/EC (pentabromodiphenyl ether, octabromodiphenyl ether)

The above Directives, enacted in EU Member States, requires that four identified metals are not present above the classification limits as per European Directive 67/548/EEC ff and Explanatory Memorandum, page 42, *Memorandum on Scientific Evaluation*, ref: COM 2000/346/final, dated: 13.06.00

Certain brominated flame-retardant additives are required not to be present above the classification limits.
Brominated flame-retardant additives have to be identified if present.

Brominated Flame Retardant additives

The resin, as delivered, does not contain any in the above Directives regulated substances above the allowed limits.

The resin, as delivered, does not contain flame retardant additives to be identified.

Heavy Metals

None of the four named heavy metals, - namely cadmium, lead, mercury and hexavalent chromium, - have been added to this product or the constituents contained in this product. Representative samples of above or similar materials have been examined to assure that potential trace contamination levels are below the required limits.

Compliance certification

Results of various analytical testing, auditing and process analysis techniques, demonstrate, that this material complies with the requirements of the

European Directive 2002/95/EC (RoHS)

European Directive 2002/96/EC (WEEE)

European Directive 2003/11/EC (pentabromodiphenyl ether, octabromodiphenyl ether).



Test Report

No. 3045231/EC

Date : Feb 28 2007

Page 1 of 4

LIANG LI PLASTICS COLOURISTS

QING HU TOU MANAGEMENT ZONE TANGXIA TOWN DONGGUAN CITY GUANGDONG CHINA

Report on the submitted sample said to be RED : 6135.6141.6170.6175.6174.6189;
ORANGE:6231;YELLOW:6306.6309.6324.6338.6341.6357.6379.6381.6387;GREEN:6422.6465;
BLUE:6523.6532.6533.6538.6554.6574;VIOLET:6663.6628.6625;BLACK:6716.6771.6732;WHITE:6069.
6834.6838.6831.6827.TC-30.6851.

SGS Job No. : 2809633
SGS Ref. No. : SZE00707213RS
Buyer : SONY
Sample Receiving Date : FEB 21 2007
Testing Period : FEB 21 - 27 2007

Test Requested : With reference to SONY SS-00259

- 1) To determine the Cadmium Content in the submitted sample.
- 2) To determine the Lead Content in the submitted sample.
- 3) To determine the Mercury Content in the submitted sample.
- 4) To determine the Hexavalent Chromium Content on the submitted sample.
- 5) Determination of PBBs (polybrominated biphenyls), PBDEs (Polybrominated diphenylethers) of the submitted sample.

Pre-conditioning and Measurement Method : 1-3) With reference to EPA Method 3051/ 3052.
Analysis was performed by Inductively Coupled Argon Plasma-Atomic Emission Spectrometry (ICP-AES).

4) With reference to EPA Method 3060A & 7196A.
The sample was alkaline-digested by using EPA Method 3060A, and then analyzed by using Colorimetric method 7196A (by UV-Vis Spectrophotometer).

5) With reference to EPA Method 3540C/ 3550C. Analysis was performed by GC/MS or LC/MS.

Test Results : 1-5) Please refer to the next page

Signed for and on behalf of
SGS Hong Kong Ltd

Ho Ka Ting, Family
Laboratory Executive

This Test Report is issued by the Company subject to its General Conditions of Service printed overleaf or attached. Said Conditions are also available upon request or are accessible at www.sgs.com. Attention is drawn to the limitations of liability, indemnification and jurisdictional policies defined therein. The results shown in this Test Report refer only to the sample(s) tested unless otherwise stated and such sample(s) are retained for 90 days only. This Test Report shall not be reproduced except in full, without written approval of the Company.

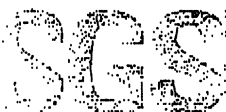

Test Report

No 3045231/EO

Date : Feb 23 2007

Page 2 of 4

Test Results

Test Item	Dk. Green Powder	Detection Limit
1) Cadmium (Cd)	ND	2 ppm
2) Lead (Pb)	ND	2 ppm
3) Mercury (Hg)	ND	2 ppm
4) Hexavalent Chromium (Cr ^{VI})	ND	2 ppm

(Results shown are of the total weight of samples)

Note : ppm = mg/kg

ND = Not Detected

Not detected is reported when the reading is less than detection limit value

5)

Flame Retardants	Dk. Green Powder	Detection Limit
Polybrominated Biphenyls (PBBs)	---	---
Monobromobiphenyl	ND	5 ppm
Dibromobiphenyl	ND	5 ppm
Tri bromobiphenyl	ND	5 ppm
Tetrabromobiphenyl	ND	5 ppm
Pentabromobiphenyl	ND	5 ppm
Hexabromobiphenyl	ND	5 ppm
Heptabromobiphenyl	ND	5 ppm
Octabromobiphenyl	ND	5 ppm
Nonabromobiphenyl	ND	5 ppm
Decabromobiphenyl	ND	5 ppm
Polybrominated Diphenylethers (PBDEs)	---	---
Monobromodiphenyl ether	ND	5 ppm
Dibromodiphenyl ether	ND	5 ppm
Tri bromodiphenyl ether	ND	5 ppm
Tetrabromodiphenyl ether	ND	5 ppm
Pentabromodiphenyl ether	ND	5 ppm
Hexabromodiphenyl ether	ND	5 ppm
Heptabromodiphenyl ether	ND	5 ppm
Octabromodiphenyl ether	ND	5 ppm
Nonabromodiphenyl ether	ND	5 ppm
Decabromodiphenyl ether	ND	5 ppm

Note : ppm = mg/kg

ND = Not Detected

Not detected is reported when the reading is less than detection limit value

Remark : Test was conducted in SGS Hong Kong Limited

This Test Report is issued by the Company subject to its General Conditions of Service printed overleaf or attached. Said Conditions are also available upon request at www.sgs.com. Attention is drawn to the limitations of liability, indemnification and jurisdictional policies contained therein. The Test Report is valid only for the purpose stated and is not to be used for any other purpose without the prior written approval of the Company. The Test Report is not to be used for any other purpose except in full written agreement with the Company.



Test Report

No. 3045231/EC

Date : Feb 23 2007

Page 3 of 4

Flow chart of digestion

(EPA 3051/3052 for Cd, Pb)

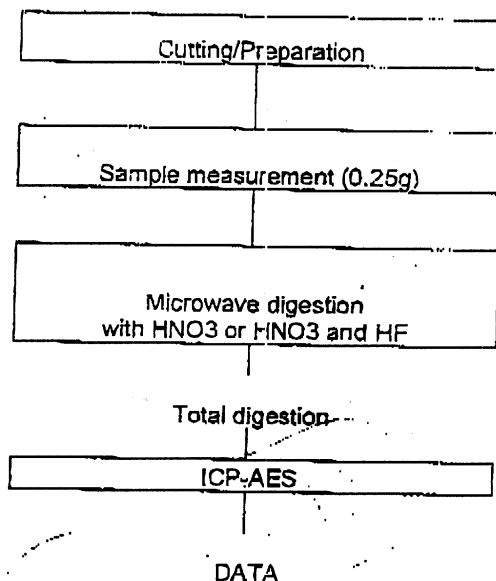

The samples were dissolved totally by pre-conditioning method according to above flow chart.

Operator

Chow Fuk Fung

Section Chief

Lee Fung Mei, Miranda

This Test Report is issued by the Company subject to its General Conditions of Service printed overleaf or attached. Said Conditions are also available upon request or are accessible at www.sgs.com. Attention is drawn to the limitations of liability, indemnification and jurisdictional policies defined therein. The results shown in this Test Report refer only to the sample(s) tested unless otherwise stated and such samples are retained for 30 days after the date of the Report. This Report shall not be reproduced except in full, without written approval of the Company.

黃明建

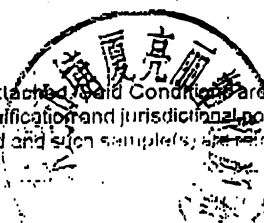



Test Report

No. 3045231/EC

Date : Feb 28 2007

Page 4 of 4

PHOTO APPENDIX

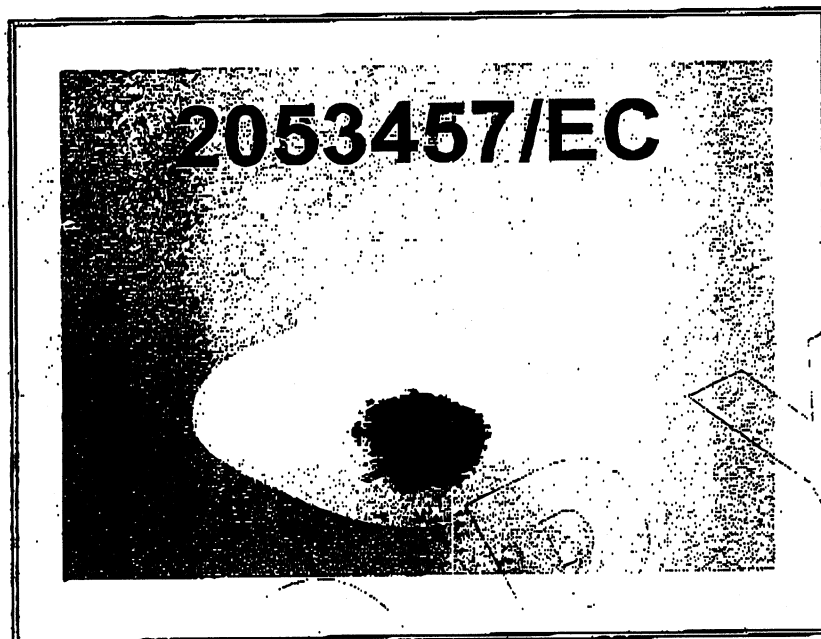

SGS authenticate the photo on original report only

*** End of Report ***

This Test Report is issued by the Company and is subject to its General Conditions of Service printed overleaf or attached. Said conditions insofar as available upon request or are accessible at www.sgs.com. Attention is drawn to the limitations of liability, indemnification and jurisdiction policies defined therein. The results shown in this Test Report refer only to the sample(s) tested unless otherwise stated and such sample(s) are retained for 30 days only. This Test Report shall not be reproduced except in full, without written approval of the Company.

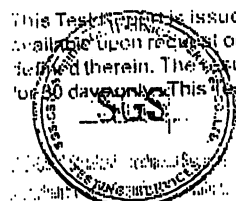

2/F, Eastar Building, Zhongkang Road, Shennanshan, Shenzhen China 518040
中国·深圳·上梅林中心路奥士达大厦21层 邮编: 518040

1 (86 755) 83114358 1 (86 755) 83114359
1 (86 755) 83114358 1 (86 755) 83114359

www.sgs.com
sgs.china.com

Member of the SGS Group (Société Générale de Surveillance)



Test Report

No.: GZ0610158575/CHEM

Date: NOV 01, 2006

Page 1 of 3

SHINYUAN ELECTRONIC CO., LTD
IN THE ROAD OF BUBU GAO, KONG BA VILLAGE, DEVELOPING ZONE, WUSHA, CHANGAN, DONG GUAN
GUANG DONG PROVINCE, CHINA

Report on the submitted sample said to be SWP 原材料

SGS Ref No. : SZ10117640-2.1
Sample Receiving Date : OCT 23, 2006
Testing Period : OCT 23, 2006 TO NOV 01, 2006

Test Requested : To determine the Cadmium, Lead, Mercury & Hexavalent Chromium content in the submitted sample.

Test Method : (1) As specified by client, with reference to BS EN 1122:2001, Method B for Cadmium Content. Analysis was performed by ICP.
(2) With reference to EPA Method 3050B:1996 for Lead Content. Analysis was performed by ICP.
(3) With reference to EPA Method 3052:1996 & EPA Method 7473:1998 for Mercury Content. Analysis was performed by ICP & Direct Mercury analyzer.
(4) With reference to IEC 62321 Ed.1 111/54/CDV for Hexavalent Chromium Content by Colorimetric Method.

Test Results : Please refer to next page.

Signed for and on behalf of
SGS-CSTC Ltd.

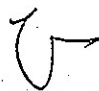
Jiang YongPing, Terry
Sr. Engineer

This Test Report is issued by the Company subject to its General Conditions of Service printed overleaf or available on request and accessible at www.sgs.com. Attention is drawn to the limitations of liability, indemnification and jurisdictional issues defined therein. Unless otherwise stated the results shown in this test report refer only to the sample(s) tested. This test report cannot be reproduced, except in full, without prior written permission of the Company. Any unauthorized alteration, forgery or falsification of the content or appearance of this report is unlawful and offenders may be prosecuted to the fullest extent of the law.

GZCM 1149418



Test Report

No.: GZ0610158575/CHEM

Date: NOV 01, 2006

Page 2 of 3

Test results by chemical method (Unit: mg/kg)

Test Item(s):	Method (refer to)	No.1	MDL
Cadmium (Cd)	(1)	N.D.	2
Lead (Pb)	(2)	N.D.	2
Mercury (Hg)	(3)	N.D.	2
Hexavalent Chromium (CrVI) by boiling water extraction	(4)	Negative	See Note (4)

Test Part Description:

No.1 Grey metal wire

Note: (1) mg/kg = ppm

(2) N.D. = Not Detected

(3) MDL = Method Detection Limit

(4) Spot-test:

Negative = Absence of CrVI coating, Positive = Presence of CrVI coating;

(The tested sample should be further verified by boiling-water-extraction method if the spot test result cannot be confirmed.)

Boiling-water-extraction:

Negative = Absence of CrVI coating

Positive = Presence of CrVI coating; the detected concentration in boiling-water-extraction solution is equal or greater than 0.02 mg/kg with 50 cm² sample surface area.

Sample photo :

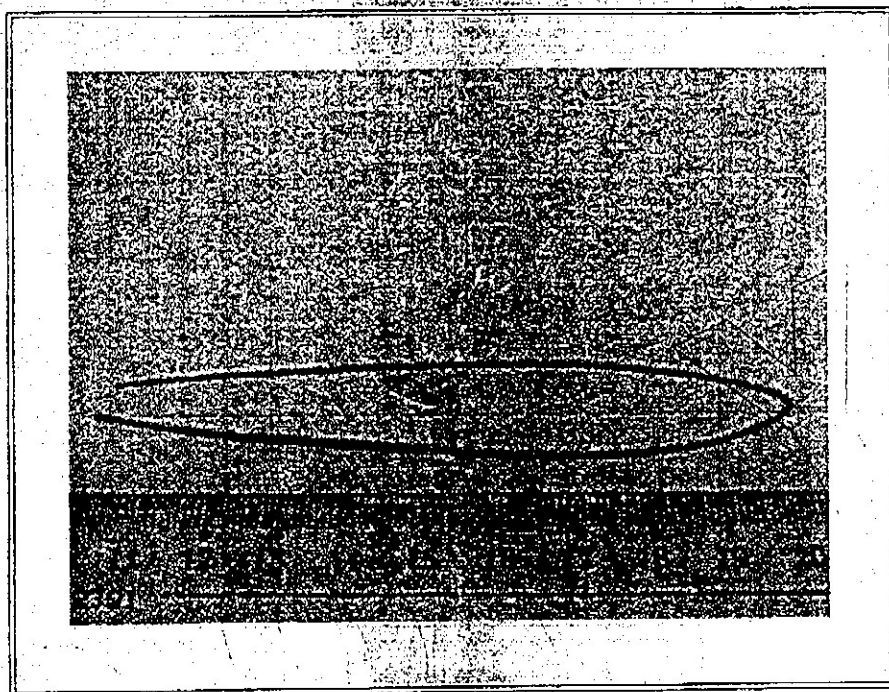

SGS authenticate the photo on original report only

*** End of Report ***

This Test Report is issued by the Company subject to its General Conditions of Service printed overleaf or available on request and accessible at www.sgs.com. Attention is drawn to the limitations of liability, indemnification and jurisdictional issues defined therein. Unless otherwise stated the results shown in this test report refer only to the sample(s) tested. This test report cannot be reproduced, except in full, without prior written permission of the Company. Any unauthorized alteration, forgery or falsification of the content or appearance of this report is unlawful and offenders will be prosecuted to the fullest extent of the law.

SGS

GZCM1149124



Test Report

No.: GZ0701012954/CHEM

Date: FEB 01, 2007

Page 1 of 3

SHINYUAN ELECTRONIC CO., LTD
IN THE ROAD OF BUBU GAO, KONG BA VILLAGE, DEVELOPING ZONE, WUSHA, CHANG AN, DONG GUAN
GUANG DONG PROVINCE CHINA

The following sample(s) was/were submitted and identified on behalf of the applicant as 有害物质检测
Client Reference: Lot No.: P07010243

SGS Ref No.: SZ10238278-12.2
Sample Receiving Date: JAN 24, 2007
Further Information Receiving Date: JAN 31, 2007
Testing Period: JAN 24, 2007 TO JAN 31, 2007

Test Requested: In accordance with the RoHS Directive 2002/95/EC and its amendment directives.

Test Method: With reference to IEC 62321 Ed 1 111/54/CDV
Procedures for the Determination of Levels of Regulated Substances in Electrotechnical Products
(1) Determination of Cadmium by ICP. (With reference to IEC 62321, Section 12.)
(2) Determination of Lead by ICP. (With reference to IEC 62321, Section 12.)
(3) Determination of Mercury by ICP. (With reference to IEC 62321, Section 10.)
(4) Determination of Hexavalent Chromium by Colorimetric Method. (With reference to IEC 62321, Section 8.5.2.)

Test Results: Please refer to next page.

Conclusion: Based on the performed tests on submitted sample(s), the results comply with the RoHS Directive 2002/95/EC and its subsequent amendments.

Signed for and on behalf of
SGS-CSTC Ltd.

Huang Fang, Sunny
Sr. Engineer

This Test Report is issued by the Company subject to its General Conditions of Service printed overleaf or available on request and accessible at www.sgs.com. Attention is drawn to the limitations of liability, indemnification and jurisdictional issues defined therein. Unless otherwise stated the results shown in this test report refer only to the sample(s) tested. This test report cannot be reproduced, except in full, without prior written permission of the Company. Any unauthorized alteration, forgery or falsification of the content or appearance of this report is unlawful and offenders may be prosecuted to the fullest extent of the law.

SGS-CSTC (Shanghai) Technical Service Co., Ltd.
Building 10, No. 1234, Lane 100, No. 1000, No. 1000

18 National Science and Technology Park, Guangzhou, China 510663
中国·广州·经济技术开发区科学城科珠路198号 邮编: 510663

1 (86-20) 82156655
1 (86-20) 82156665

1 (86-20) 82075126
1 (86-20) 82075126

www.sgs.com
sgs.china@sgs.com

GZCM 1242294

Member of the SGS Group (SGS SA)



Test Report

No. GZ0701012854/CHEM

Date: FEB 01, 2007

Page 2 of 3

Test results by chemical method (Unit: mg/kg)

Test Item(s):	Method (reference):	No. 1	MDL	RoHS Limit
Cadmium (Cd)	(1)	N.D.	2	100
Lead (Pb)	(2)	N.D.	2	1000
Mercury (Hg)	(3)	N.D.	2	1000
Hexavalent Chromium (CrVI) by boiling water extraction	(4)	Negative	See Note 4	#

Test Part Description:

No. 1 Black plated metal wire

Note: 1. mg/kg = ppm

2. N.D. = Not Detected (< MDL)

3. MDL = Method Detection Limit

4. Spot-test:

Negative = Absence of CrVI coating, Positive = Presence of CrVI coating

(The tested sample should be further verified by boiling-water-extraction method if the spot test result cannot be confirmed.)

Boiling-water-extraction:

Negative = Absence of CrVI coating

Positive = Presence of CrVI coating; the detected concentration in boiling-water-extraction solution is equal or greater than 0.02 mg/kg with 60 cm² sample surface area.

5. # = Positive indicates the presence of CrVI on the tested areas and result be regarded as conflict with RoHS requirement.

Negative indicates the absence of CrVI on the tested areas and result be regarded as no conflict with RoHS requirement.

This Test Report is issued by the Company subject to its General Conditions of Service printed overleaf or available on request and accessible at www.sgs.com. Attention is drawn to the limitations of liability, indemnification and jurisdictional issues defined therein. Unless otherwise stated, the results shown in this test report refer only to the sample(s) tested. This test report cannot be reproduced, except in full, without prior written permission of the Company. Any unauthorized alteration, forgery or falsification of the content or appearance of this report is unlawful and offenders will be prosecuted to the fullest extent of the law.

SGS-CSI (China) Technical Service Co., Ltd.
Guangzhou Sub-office

18th Floor, SCIT Tower, Guangzhou Science City, Guangzhou, China 510663
中国·广州·经济技术开发区科学城明珠路18号 邮编: 510663

Tel: (86-20) 82135555
Fax: (86-20) 82135555

Tel: (86-20) 82075125
Fax: (86-20) 82075125

www.cn.sgs.com
e: sgschina@sgs.com

Member of the SGS Group (SGS SA)

Mar. 20 2007 07:00PM P2

FAX NO. :

FROM : SHINYUAN

SGS**Test Report**

No. GZ0701012954/CHEM

Date: FEB 01, 2007

Page 3 of 3

Sample photo :

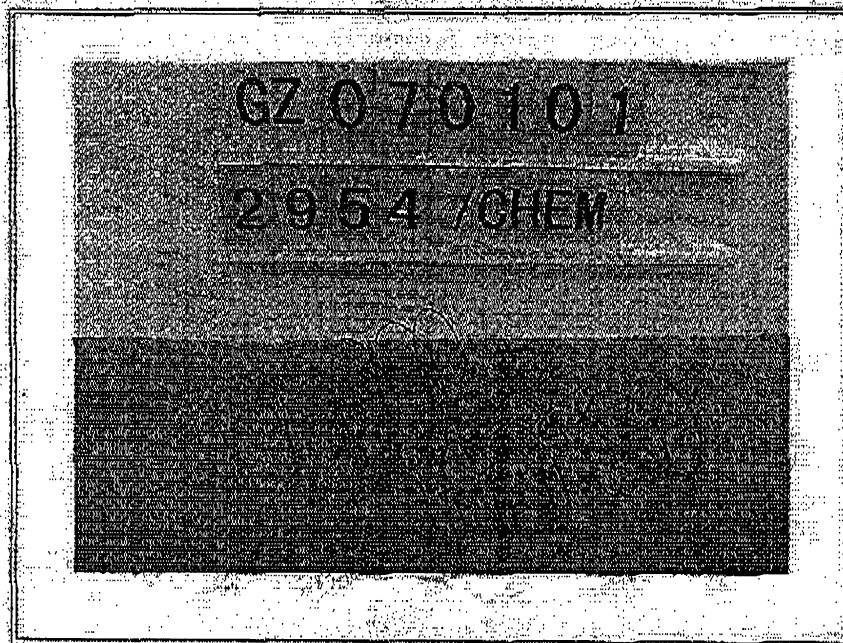

SGS authenticates the photo on original report only

*** End of Report ***

This Test Report is issued by the Company subject to its General Conditions of Service printed overleaf or available on request and accessible at www.sgs.com. Attention is drawn to the limitations of liability, indemnification and jurisdictional issues defined therein. Unless otherwise stated, the results shown in any test report refer only to the sample(s) tested. This test report cannot be reproduced, except in full, without prior written permission of the Company. Any unauthorized alteration, forgery or falsification of the content or appearance of this report is unlawful and offenders may be prosecuted to the fullest extent of the law.

SGS (China) Technical Service Co., Ltd.
Guangzhou Branch

380 Kaili Road, Science City, Guangzhou, China 510663
中国·广州·经济技术开发区科学城科兴路198号 邮编: 510663

Tel: (86-20) 82155555
Fax: (86-20) 82155555

Tel: (86-20) 82075125
Fax: (86-20) 82075125

www.cn.sgs.com
B: sgs.china@sgs.com

GZCM 1242679

Member of the SGS Group (SGSSA)

Test Report

No. SH6083852/CHEM

Date: Jul. 11, 2006

Page 1 of 3

HANGZHOU SILAN OPTRONICS CO., LTD
NO.500 BINGKANG ROAD, HANGZHOU CITY, ZHENJIANG, CHINA

Report on the submitted sample said to be fibre optic module.

SGS Ref No. : 10008889-1
Model : TOS-2
Main substance : COPPER, EPOXY

Sample Receiving Date : Jul.05, 2006
Testing Period : Jul.05 – 10, 2006

Test Requested : 1) To determine the Cadmium Content in the submitted samples. No.1~No.2
2) To determine the Lead Content in the submitted samples. No.1~No.2
3) To determine the Mercury Content in the submitted samples. No.1~No.2
4) To determine the Hexavalent Chromium Content on the submitted samples.
No.1~No.2
5) To determine the PBBs(Polybrominated biphenyls) PBBEs(PBDEs)
(Polybrominated biphenyl ethers) Content of the submitted sample. No.1

Test Method : 1) With reference to BS EN 1122:2001, Method B, or other acid digestion.
Analysis was performed by Inductively Coupled Argon Plasma-Atomic Emission Spectrometry (ICP-AES) or Atomic Absorption Spectrometry.
2) With reference to EPA Method 3050B/ 3051/ 3052, or other acid digestion
Analysis was performed by Inductively Coupled Argon Plasma-Atomic Emission Spectrometry (ICP-AES) or Atomic Absorption Spectrometry.
3) With reference to US EPA 3052 or other acid digestion, Analysis was performed by Inductively Coupled Argon Plasma – Atomic Emission Spectrometry (ICP-AES) or US EPA7473 Analysis was performed by Hg Analyzer.
4) With reference to EPA Method 3060A & 7196A.
The samples were alkaline digested by using EPA Method 3060A, and then analyzed by using Colorimetric method 7196A(by UV-Vis Spectrophotometer).
5) With reference to USEPA 8081A/8270D/3540C/3550C, Analysis was performed by GC-MS.

Test Results : Please refer to next page

Signed for and on behalf of
SGS-CSTC Chemical Laboratory

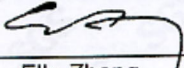
Ella Zhang
Sr. Section Head

Signed for and on behalf of
SGS-CSTC Chemical Laboratory

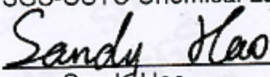
Sandy Hao
Lab Manager

This Test Report is issued by the Company subject to its General Conditions of Service printed overleaf or attached. Said Conditions are also available upon request or are accessible at www.sgs.com. Attention is drawn to the limitations of liability, indemnification and jurisdictional policies defined therein. The results shown in this Test Report refer only to the sample(s) tested unless otherwise stated and such sample(s) are retained for 90 days only. This Test Report shall not be reproduced except in full, without written approval of the Company.

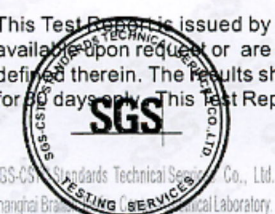

SHCHEM 523459

SGS-CSTC Standards Technical Service Co., Ltd.
Shanghai Branch Chemical Laboratory

10/F, 3rd Building, No.889, Yishan Road, Shanghai, China 200233
中国·上海·宜山路889号3号楼10层 邮编:200233

t (86-21)61402666 * 2720
t (86-21)61402553

f (86-21)54500314
f (86-21)54500314

www.cn.sgs.com
e sgs.china@sgs.com

Test Report

No. SH6083852/CHEM

Date: Jul. 11, 2006

Page 2 of 3

Test Results

No.	Item	Unit	DL	No.1**
1	Cadmium (Cd)	mg/kg	2	N.D.
2	Lead (Pb)	mg/kg	2	20
3	Mercury (Hg)	mg/kg	2	N.D.
4	Hexavalent Chromium (Cr VI)*	mg/kg	2	N.D.
5	Polybrominated biphenyls (PBBs)	---	---	---
	Monobromobiphenyl	mg/kg	5	N.D.
	Dibromobiphenyl	mg/kg	5	N.D.
	Tribromobiphenyl	mg/kg	5	N.D.
	Tetrabromobiphenyl	mg/kg	5	N.D.
	Pentabromobiphenyl	mg/kg	5	N.D.
	Hexabromobiphenyl	mg/kg	5	N.D.
	Heptabromobiphenyl	mg/kg	5	N.D.
	Octabromobiphenyl	mg/kg	5	N.D.
	Nonabromobiphenyl	mg/kg	5	N.D.
	Decabromobiphenyl	mg/kg	5	N.D.
	Polybrominated biphenyl ethers (PBDEs(PBDEs))	---	---	---
	Monobromobiphenyl ether	mg/kg	5	N.D.
	Dibromobiphenyl ether	mg/kg	5	N.D.
	Tribromobiphenyl ether	mg/kg	5	N.D.
	Tetrabromobiphenyl ether	mg/kg	5	N.D.
	Pentabromobiphenyl ether	mg/kg	5	N.D.
	Hexabromobiphenyl ether	mg/kg	5	N.D.
	Heptabromobiphenyl ether	mg/kg	5	N.D.
	Octabromobiphenyl ether	mg/kg	5	N.D.
	Nonabromobiphenyl ether	mg/kg	5	N.D.
	Decabromobiphenyl ether	mg/kg	5	N.D.

This Test Report is issued by the Company subject to its General Conditions of Service printed overleaf or attached. Said Conditions are also available upon request or are accessible at www.sgs.com. Attention is drawn to the limitations of liability, indemnification and jurisdictional policies defined therein. The results shown in this Test Report refer only to the sample(s) tested unless otherwise stated and such sample(s) are retained for 90 days only. This Test Report shall not be reproduced except in full, without written approval of the Company.



SHCHEM 523458

SGS Standards Technical Services Co., Ltd.
Shanghai Branch

10/F, 3rd Building, No.889, Yishan Road, Shanghai, China 200233
中国·上海·宜山路889号3号楼10层 邮编:200233

t (86-21)61402666 * 2720
t (86-21)61402553

f (86-21)54500314
f (86-21)54500314

www.cn.sgs.com
e sgs.china@sgs.com

Member of SGS Group (Société Générale de Surveillance)

Test Report

No. SH6083852/CHEM

Date: Jul. 11, 2006

Page 3 of 3

No.	Item	Unit	DL	No.2
1	Cadmium (Cd)	mg/kg	2	N.D.
2	Lead (Pb)	mg/kg	2	45
3	Mercury (Hg)	mg/kg	2	N.D.
4	Hexavalent Chromium (Cr VI)*	mg/kg	2	N.D.

Sample Appearance Description(Photo see appendix):

No.1 Transparent body (without pin)

No.2 Silvery metal pin

Note : 1mg/kg=1ppm=0.0001%

DL= Detection Limit

N.D. = Not detected

Not Detected is reported when the reading is less than detection limit value.

* As requested by client, EPA 3060A/7196A were used for determination of the sample

** The sample(s) was analyzed on behalf of the applicant as mixing whole/part sample in one testing.
The result(s) in report means average of whole sample. The result(s) will be different obviously if the sample(s) was tested as requirement of RoHS, and result(s) may be higher than that of report. The applicant will take the responsibility of all discrepancy and risk.

*** End of Report ***

COPY

This Test Report is issued by the Company subject to its General Conditions of Service printed overleaf or attached. Said Conditions are also available upon request or are accessible at www.sgs.com. Attention is drawn to the limitations of liability, indemnification and jurisdictional policies defined therein. The results shown in this Test Report refer only to the sample(s) tested unless otherwise stated and such sample(s) are retained for 90 days only. This Test Report shall not be reproduced except in full, without written approval of the Company.



10/F, 3rd Building, No.889, Yishan Road, Shanghai, China 200233

中国·上海·宜山路889号3号楼10层 邮编:200233

t (86-21)61402666*2720

t (86-21)61402553

f (86-21)54500314

f (86-21)54500314

www.cn.sgs.com

e sgs.china@sgs.com

SHCHEM 523373

Member of SGS Group (Société Générale de Surveillance)

Test Report

No.: GZ0612188826/CHEM

Date: DEC 27, 2006

Page 1 of 3

BO YI METAL ELECTRO FTY
HUANGXI SHI WAN TOWN BOLUO COUNTY GUANG DONG PROVINCE

The following sample(s) was/were submitted and identified on behalf of the applicant as TC

SGS Ref No. : SZ10198217-4.4
Sample Receiving Date : DEC 21, 2006
Testing Period : DEC 21, 2006 TO DEC 27, 2006

Test Requested : In accordance with the RoHS Directive 2002/95/EC, and its amendment directives.

Test Method : With reference to IEC 62321 Ed.1 111/54/CDV
Procedures for the Determination of Levels of Regulated Substances in Electrotechnical Products
(1) Determination of Cadmium by ICP.
(2) Determination of Lead by ICP.
(3) Determination of Mercury by ICP.
(4) Determination of Hexavalent Chromium by Colorimetric Method.

Test Results : Please refer to next page.

Conclusion : Based on the performed tests on submitted sample(s), the results **comply with** the RoHS Directive 2002/95/EC and its subsequent amendments.

Signed for and on behalf of
SGS-CSTC Ltd.

Jiang YongPing, Terry
Sr. Engineer

This Test Report is issued by the Company subject to its General Conditions of Service printed overleaf or available on request and accessible at www.sgs.com. Attention is drawn to the limitations of liability, indemnification and jurisdictional issues defined therein. Unless otherwise stated the results shown in this test report refer only to the sample(s) tested. This test report cannot be reproduced, except in full, without prior written permission of the Company. Any unauthorized alteration, forgery or falsification of the content or appearance of this report is unlawful and offenders may be prosecuted to the fullest extent of the law.

SGS TESTING SERVICE

198 Kezhu Road, SCIENTECH Park Guangzhou Economic & Technology Development District, Guangzhou, China 510663
中国·广州·经济技术开发区科学城科珠路198号 邮编: 510663

t (86-20) 82155555
t (86-20) 82155555

f (86-20) 82075125
f (86-20) 82075125

www.cn.sgs.com
sgs.china@sgs.com

GZCM1019148



Test Report

No.: GZ0612188826/CHEM

Date: DEC 27, 2006

Page 2 of 3

Test results by chemical method (Unit: mg/kg)

Test Item(s):	Method (refer to)	No.1	MDL	RoHS Limit
Cadmium(Cd)	(1)	N.D.	2	100
Lead (Pb)	(2)	N.D.	2	1000
Mercury (Hg)	(3)	N.D.	2	1000
Hexavalent Chromium (CrVI) by boiling water extraction	(4)	Negative	See Note 4	#

Test Part Description:

No.1 Silvery plated metal

Note : 1. mg/kg = ppm

2. N.D. = Not Detected (< MDL)

3. MDL = Method Detection Limit

4. Spot-test:

Negative = Absence of CrVI coating, Positive = Presence of CrVI coating;

(The tested sample should be further verified by boiling-water-extraction method if the spot test result cannot be confirmed.)

Boiling-water-extraction:

Negative = Absence of CrVI coating

Positive = Presence of CrVI coating; the detected concentration in boiling-water-extraction solution is equal or greater than 0.02 mg/kg with 50 cm² sample surface area.

5. # = Positive indicates the presence of CrVI on the tested areas and result be regarded as conflict with RoHS requirement.

Negative indicates the absence of CrVI on the tested areas and result be regarded as no conflict with RoHS requirement.

This Test Report is issued by the Company subject to its General Conditions of Service printed overleaf or available on request and accessible at www.sgs.com. Attention is drawn to the limitations of liability, indemnification and jurisdictional issues defined therein. Unless otherwise stated the results shown in this test report refer only to the sample(s) tested. This test report cannot be reproduced, except in full, without prior written permission of the Company. Any unauthorized alteration, forgery or falsification of the content or appearance of this report is unlawful and offenders may be prosecuted to the fullest extent of the law.

SGS (China) Technical Service Co., Ltd.
198 Kezhu Road, SCIENTECH Park, Economic & Technology Development District, Guangzhou, China 510663

198 Kezhu Road, SCIENTECH Park, Economic & Technology Development District, Guangzhou, China 510663

中国·广州·经济技术开发区科学城科珠路198号 邮编: 510663

t (86-20) 82155555

t (86-20) 82155555

f (86-20) 82075125

f (86-20) 82075125

www.cn.sgs.com

e sgs.china@sgs.com

GZCM1018809

Member of the SGS Group (SGS SA)

Sample photo :

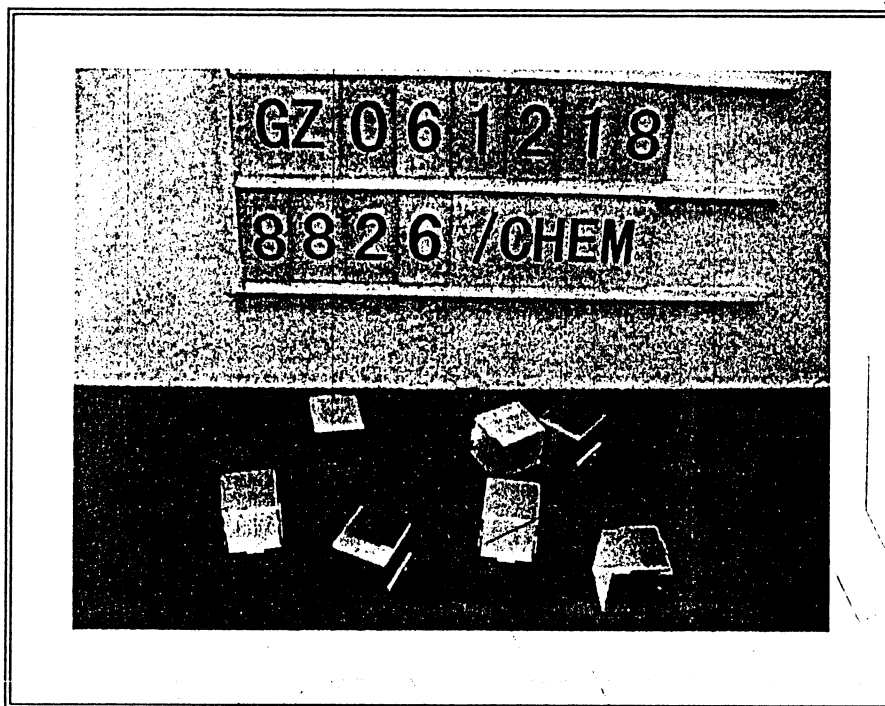

SGS authenticate the photo on original report only

*** End of Report ***

This Test Report is issued by the Company subject to its General Conditions of Service printed overleaf or available on request and accessible at www.sgs.com. Attention is drawn to the limitations of liability, indemnification and jurisdictional issues defined therein. Unless otherwise stated the results shown in this test report refer only to the sample(s) tested. This test report cannot be reproduced, except in full, without prior written permission of the Company. Any unauthorized alteration, forgery or falsification of the content or appearance of this report is unlawful and offenders may be prosecuted to the fullest extent of the law.