



## 12mm Metal Shaft Rotary Potentiometers

**R1212N**



**Part Number**

**R1212N - B 50K, L - 20 F / M**

Taper ↓ Resistance Value ↓ Shaft Type ↓  
Shaft Length ↓ Metal ↓

Dimensions

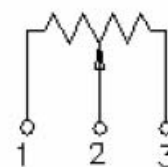
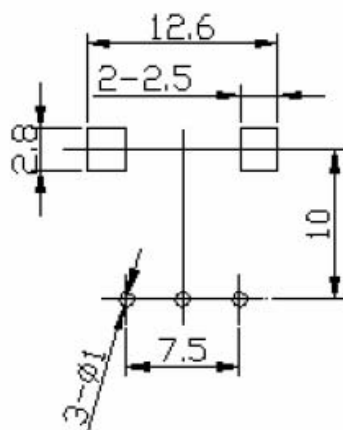
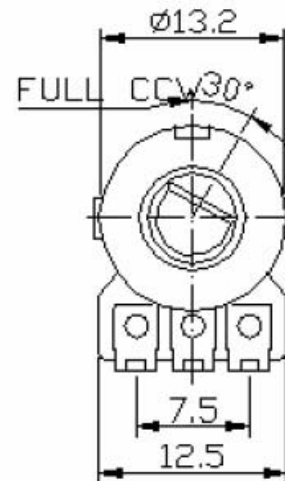
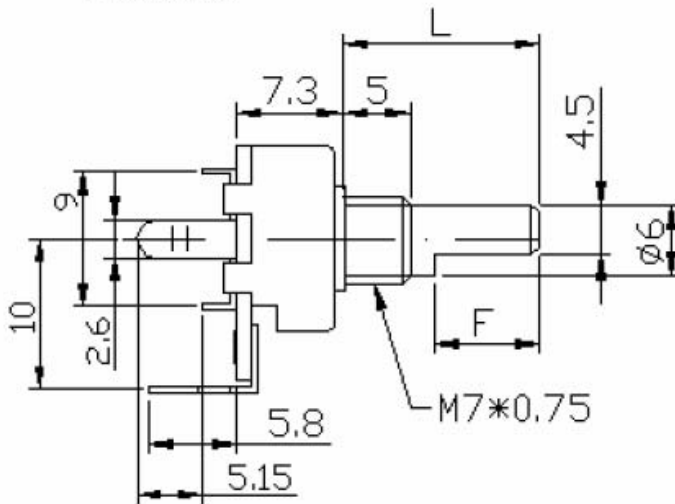



## 12mm Metal Shaft Rotary Potentiometers

**R1213N**



**Part Number**

**R1213N - B 50K, L - 20 F / M**

Taper ↓ Resistance Value ↓ Shaft Type ↓  
Shaft Length ↓ Metal ↓

Dimensions

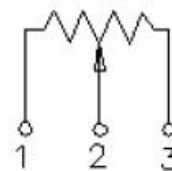
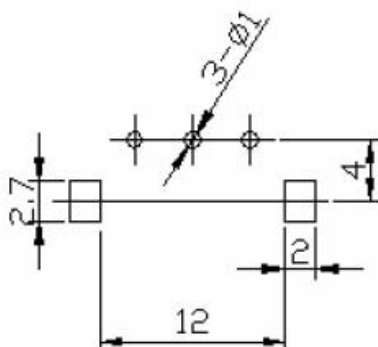
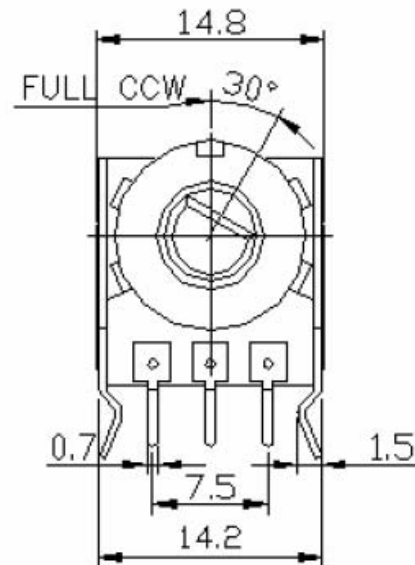
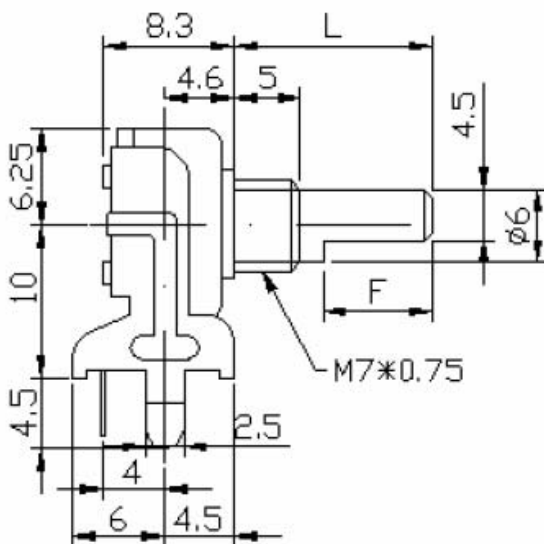



## 12mm Metal Shaft Rotary Potentiometers

**R1214G**



**Part Number**

**R1214G - B 50K, L - 20 F / M**

Taper ↓ Resistance Value ↓ Shaft Type ↓  
Shaft Length ↓ Metal ↓

Dimensions

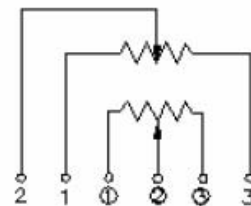
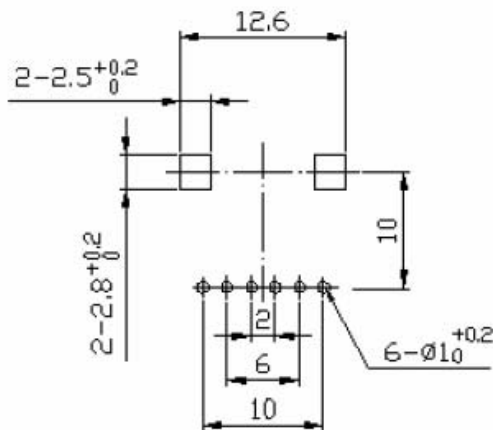
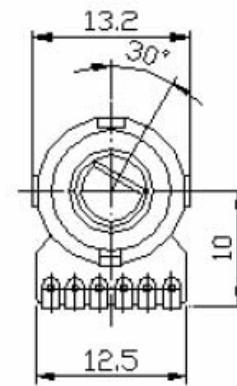
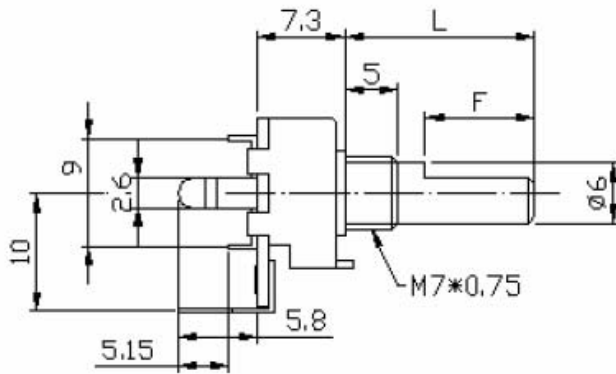



## 12mm Metal Shaft Rotary Potentiometers

**R1217G**



**Part Number**

**R1217G - B 50K, L - 20 F / M**

Taper ↓ Resistance Value ↓ Shaft Type ↓  
Shaft Length ↓ Metal ↓

Dimensions

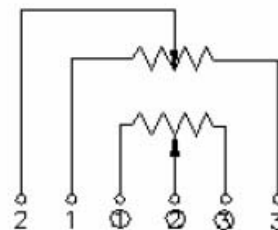
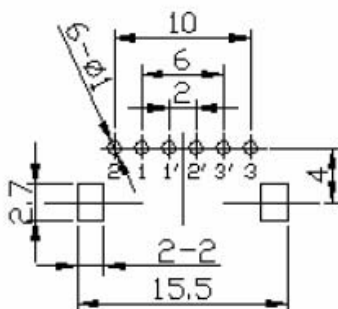
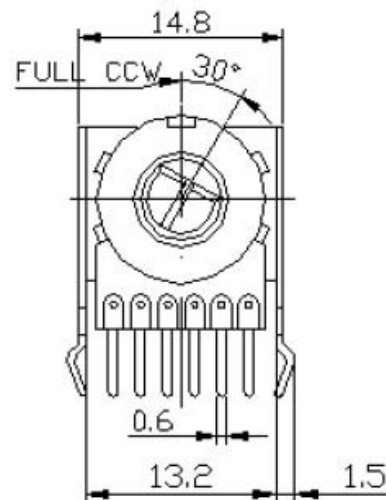
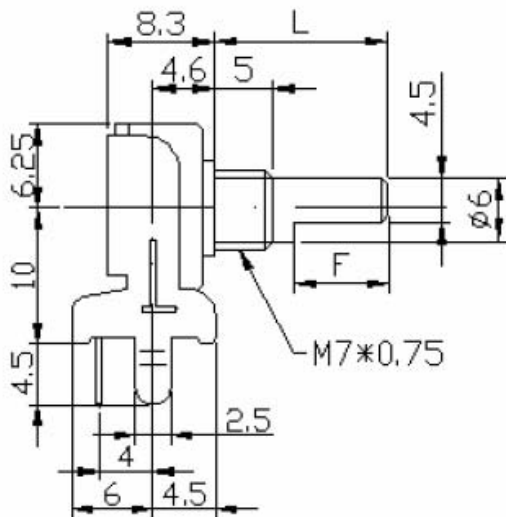

**12mm Metal Shaft Rotary Potentiometers****Electrical Characteristics**

Total Resistance	1K ~ 2M $\Omega$				
Total Resistance Tolerance	$\pm 20\%$				
Resistance Taper	A. B. C. D. W. Taper				
Resistance Taper Characteristics	A50%	B50%	C50%	D50%	W50%
	15-25%	40-60%	75-85%	2-15%	45-55%
Rated Power	0.05 W				
Residual Resistance	$R \geq 250K\Omega$ 0.1%				
	$250K\Omega > R > 10K\Omega$		20 $\Omega$ Max.		
	$10K\Omega \geq R$		20 $\Omega$ Max.		
Gang Error	-40 ~ 0db $\leq 3$ db				
Noise	47 mV Max.				
Max. Operating Voltage	DC 20 V.				
Insulation Resistance	More than 100M $\Omega$ at DC 250V				
Withstand Voltage	1 minute at AC 300V				
Rotational Life	15,000 Cycles				

**Mechanical Characteristics**

Total Rotational Angle	300° $\pm 5^\circ$
Stopper Strength	3kgf.cm max./3 Sec .
Rotational Torque	30 ~ 200 gf.cm
Shaft Pull-Push Strength	8kgf.cm max./3 Sec.
Shaft Lever Wobble	0.7x L/20mmp-p max.
Center Click Torque	150 ~ 300 g.cm
Shaft Bending	0.3mm max.
Soldering Heat	300°C, 3s. (Only for Hand-Soldering)
Remark	♣ Insulated shaft of black.