



Micro Series Slide Potentiometers

SL-20V



Part Number

SK-20V - B 50K, L - 20 C

↓ Taper ↓ Resistance Value ↓ Shaft Length ↓ Shaft Type

Dimensions

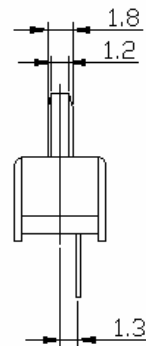
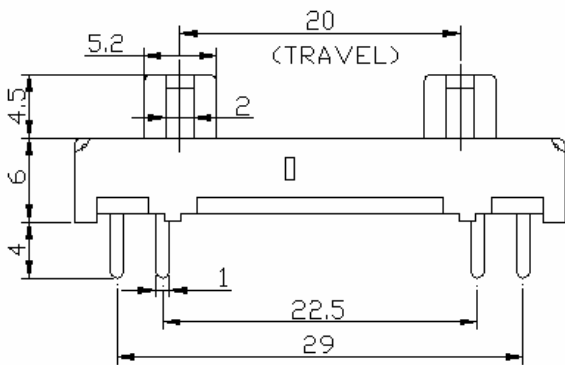
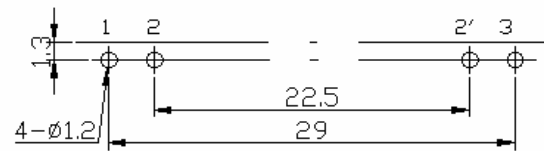
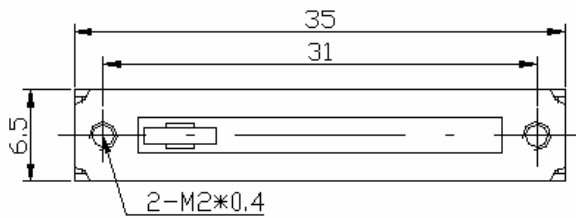

Insulated Lever:

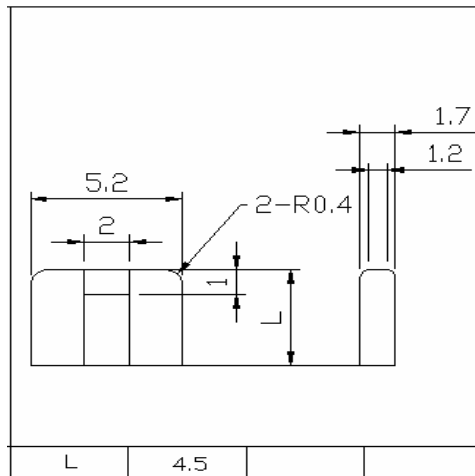

L	4.5		
---	-----	--	--

Micro Series Slide Potentiometers

Electrical Characteristics

Total Resistance	500Ω~500KΩ			
Total Resistance Tolerance	± 20%			
Resistance Taper	A. B. C. W. Taper			
Resistance Taper Characteristics	A50%	B50%	C50%	W50%
	15-25%	40-60%	75-85%	45-55%
Rated Power	B Taper: AC200V 0.1 W; Other Tapers: AC150V 0.05 W			
Residual Resistance	R³ 250KΩ 0.1%			
	250KΩ > R > 10KΩ		20ΩMax. (between Term. 1, 2)	
	10KΩ³ R		20ΩMax. (between Term. 2, 3)	
Noise	100mV Max.			
Insulation Resistance	DC 250V 50MΩ			
Withstand Voltage	1 minute at AC 250V			
Sliding Life	10,000 Cycles			

Mechanical Characteristics

Overall Travel	20 mm ± 0.5 mm
Stopper Strength	3 kgf.cm max. / 3 sec.
Operating Force	20~200gf.cm
Lever Push-Pull Strength	10 N (1.0 kgf.cm max./3 sec.)
Lever Wobble	2(2*L)/20 mm max. (L:lever length both side)
Bending Moment	25mN.m (250gf.cm)

Click slip-out force	30gf.cm ~ 300gf.cm
Soldering Heat	300°C, 3sec. (Only for Hand-Soldering)
Lever Deviation	0.5 max. (one side)